

FOR LEASE

8,100 ± SF + 13,000 SF BASEMENT (SUB-DIVIDABLE)

1690-1692 MASSACHUSETTS AVENUE
(Former Cohoes) Lexington, Massachusetts



FOR MORE INFORMATION:

ADAM CONVISER

adam@conviserpg.com

Mobile: (617) 593-1700

JIM CONVISER

jim@conviserpg.com

Mobile: (617) 839-0456

SCOTT MORIYAMA

scott@conviserpg.com

Mobile: (781) 799-8184

CONVISER PROPERTY GROUP, INC 858 Washington Street, Suite 306, Dedham, MA 02026

Office: (781) 320-0600 / Fax: (617) 663-6300 / www.conviserpg.com

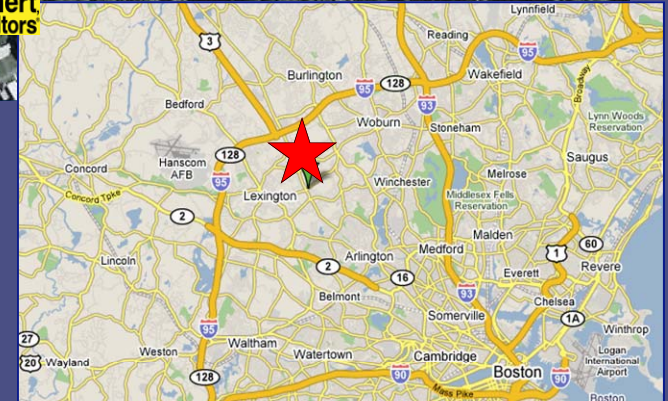

No warranty or representation, expressed or implied, is made as to the accuracy of the information contained herein, and same is submitted subject to errors, omissions, change in price, rental or other conditions, or withdrawal without notice.

1690-1692 MASSACHUSETTS AVENUE

Lexington, Massachusetts

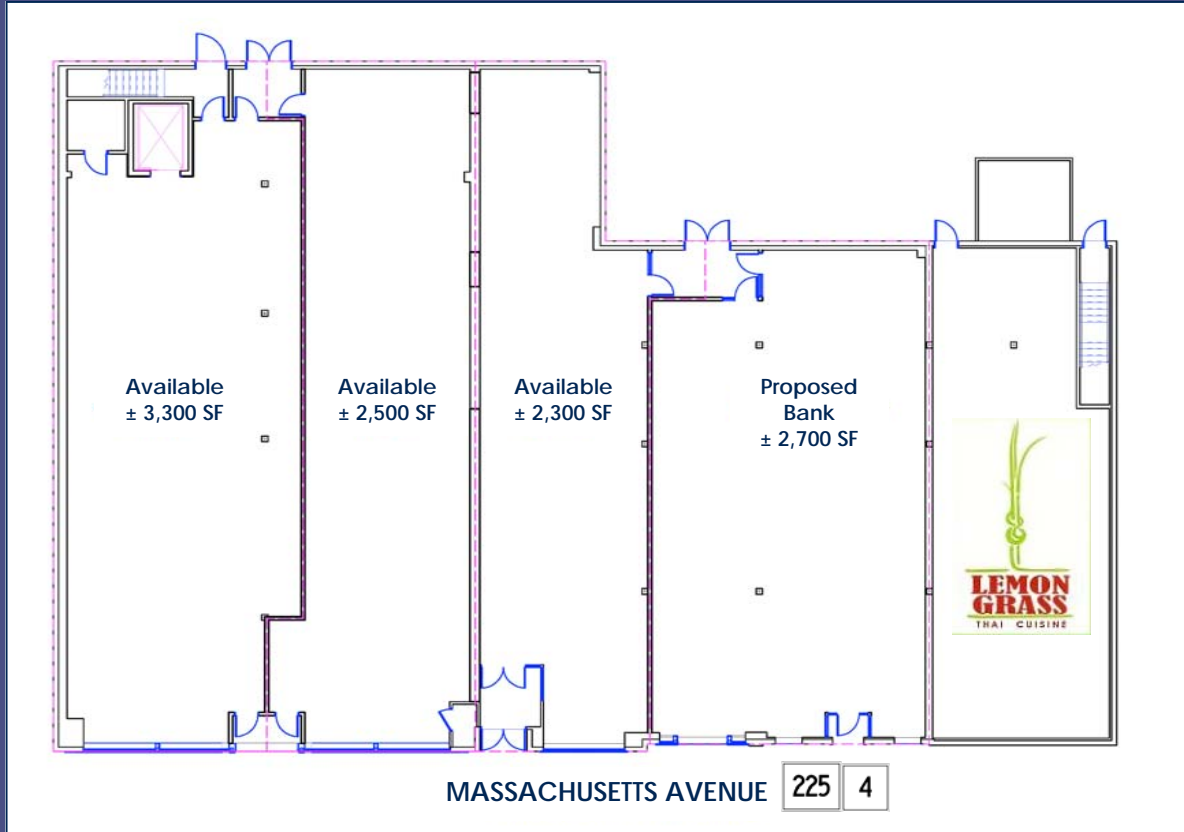

PROJECT INFORMATION:

SPACE AVAILABLE: 8,100 ± SF Sub-Dividable AVAILABILITY: IMMEDIATE
 PARKING: 84 spaces TRAFFIC COUNTS: 22,000

DEMOGRAPHIC INFORMATION:

	1 Mile	3 Mile	5 Mile
POPULATION	7,192	59,483	191,142
MEDIAN HH INCOME	\$113,133	\$96,495	\$85,607
DAYTIME POPULATION	7,025	51,196	130,522
SOME COLLEGE +	85.5%	78.5%	74.6%

FOR MORE INFORMATION:

ADAM CONVISER
adam@conviserpg.com
 Mobile: (617) 593-1700

JIM CONVISER
jim@conviserpg.com
 Mobile: (617) 839-0456

SCOTT MORIYAMA
scott@conviserpg.com
 Mobile: (781) 799-8184