

1690- 1692 MASSACHUSETTS AVENUE (ROUTE 4/225) - LEXINGTON, MASSACHUSETTS

Available: One Space Left - 2,350 ± SF

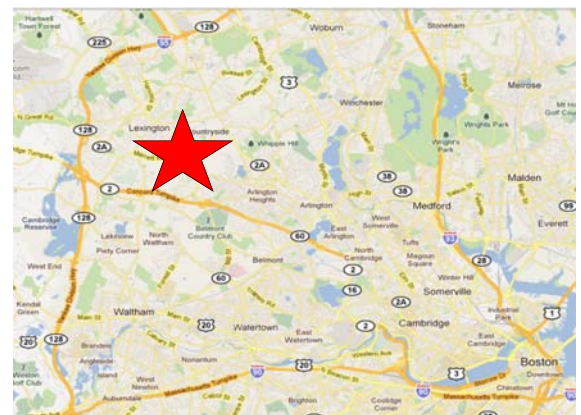

CONVISER PROPERTY GROUP, INC.

858 WASHINGTON STREET - SUITE 306, DEDHAM, MA 02026
OFFICE: (781) 320-0600 ■ FAX: (781) 791-4955 ■ WWW.CONVISERPG.COM

FOR MORE INFORMATION:

ADAM CONVISER ■ ADAM@CONVISERPG.COM ■ MOBILE: (617) 593-1700
JIM CONVISER ■ JIM@CONVISERPG.COM ■ MOBILE: (617) 839-0456



No warranty or representation, expressed or implied, is made as to the accuracy of the information contained herein, and same is submitted subject to errors, omissions, change in price, rental or other conditions, or withdrawal without notice.

**1690-1692 MASSACHUSETTS AVENUE
(ROUTE 4/225) - LEXINGTON, MASSACHUSETTS**
Available: One Space Left - 2,350 ± SF

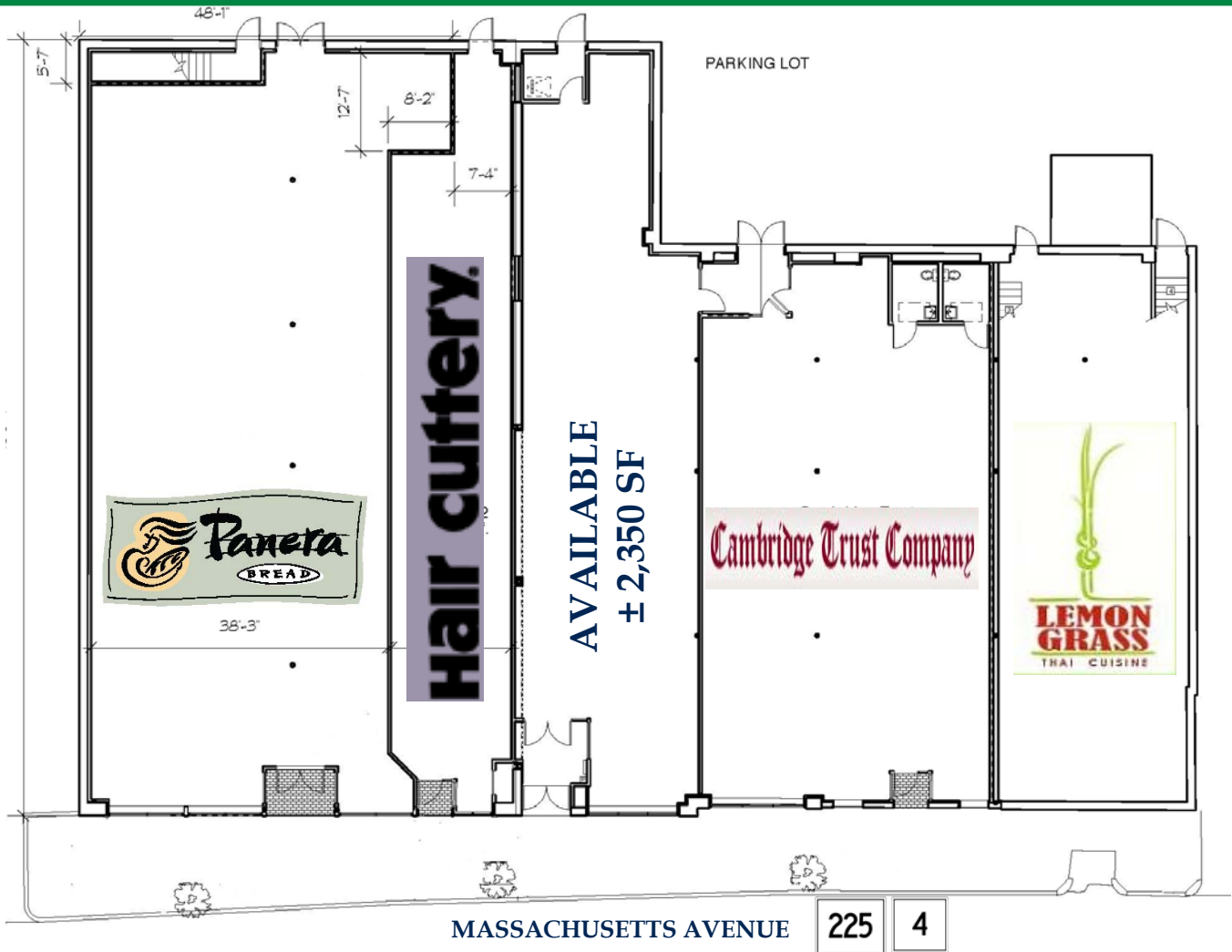

PROJECT INFORMATION:

SPACE AVAILABLE: 2,350 ± SF
PARKING: 84 Spaces

AVAILABILITY: IMMEDIATE
TRAFFIC COUNTS: 22,000

DEMOGRAPHIC INFORMATION:

| | 1 Mile | 3 Mile | 5 Mile |
|--------------------|-----------|----------|----------|
| POPULATION | 7,192 | 59,483 | 191,142 |
| MEDIAN HH INCOME | \$113,133 | \$96,495 | \$85,607 |
| DAYTIME POPULATION | 7,025 | 51,196 | 130,522 |
| SOME COLLEGE + | 85.5% | 78.5% | 74.6% |

CONVISER PROPERTY GROUP, INC.

858 WASHINGTON STREET - SUITE 306, DEDHAM, MA 02026
 OFFICE: (781) 320-0600 ■ FAX: (781) 791-4955 ■ WWW.CONVISERPG.COM

FOR MORE INFORMATION:

ADAM CONVISER ■ ADAM@CONVISERPG.COM ■ MOBILE: (617) 593-1700
 JIM CONVISER ■ JIM@CONVISERPG.COM ■ MOBILE: (617) 839-0456



No warranty or representation, expressed or implied, is made as to the accuracy of the information contained herein, and same is submitted subject to errors, omissions, change in price, rental or other conditions, or withdrawal without notice.